



## AMPLIROLL AL3PA – Container 2800 /3200

**AMPLIROLLS**



Technical data		AL3PA26	AL3PA28	AL3PA30
Type of vehicle	Axis	2	2	2
Gross Vehicle Weight (GVW)	ton	3,5 - 4,5	3,5 - 4,5	3,5 - 4,5
Lifting and tipping capacity*	Kg	3000	3000	3000
Container length **** ( mini / maxi )	mm	2200/ 2800	2200/ 3000	2400/ 3200
Loading angle **(nominal )	°	31°	31°	31°
Tipping / dumping angle	°	50°	50°	50°
Max operating pressure	bars	270	270	270
Recommended oil flow (nominal)	L/min	12	12	12
Oil tank capacity	L	8	8	8
Operational time		15l/min	15l/min	15l/min
· Loading	s	21	21	21
· Unloading	s	29	29	29
Equipment own weight ***	Kg	400	410	410

\* Body at nominal length - \*\*With hook height of 1425 mm and chassis height of 1100 mm –  
\*\*\*Equipment installed + pump + oil. \*\*\*\* Body with mini rear overhang 420 mm

Indicated figures in this document are for information only and can be changed without any prior notice.

# AMPLIROLL AL3PA : H 920



## Adaptation to all truck GvW 3,5 to 4,8 t (according to wheelbase)

### Main advantages AL3PA :

- ❖ The tilting Jib for optimization of the loading angle.
- ❖ Tilting frame used for the tipping mode.
- ❖ Main arm powered by one central double acting cylinder equipped with check valve.
- ❖ Hook equipped with mechanical safety latch.
- ❖ Sub frame with different width to suit with truck frame and reduced rail width for special bodies ( 850 mm )
- ❖ Directional valve bank pre-installed.

- ❖ Fast deployment due to single main arm cylinder.
- ❖ Tipping angle up to 50°
- ❖ Rear hydraulic locking of the container
- ❖ Automatic positive locking Main arm / tilting frame
- ❖ Pre-drilled body for easier mounting on truck frame
- ❖ Low tare weight for enhanced payload
- ❖ Maintain the original rear under-ride bumper of the truck.

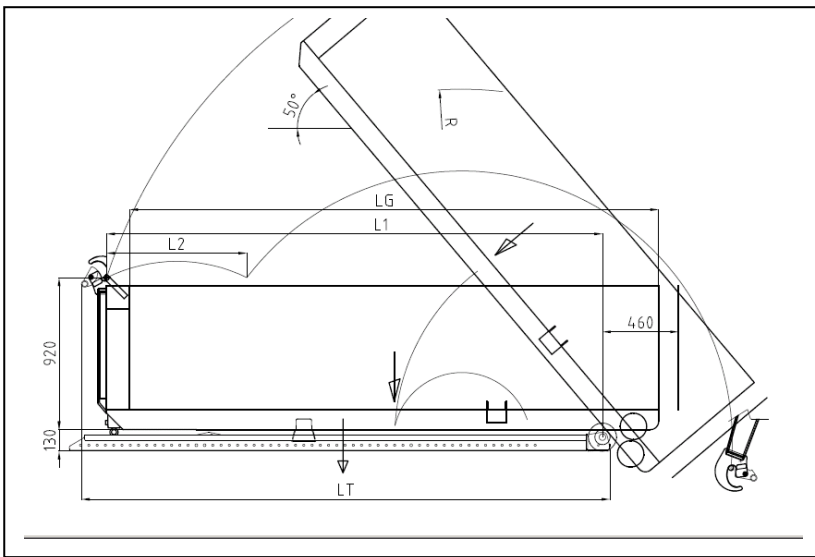

Equipment designation	AL3PA26	AL3PA28	AL3PA30
<b>LG</b> Nominal body length	2800	3000	3200
<b>P</b> Rear overhang ( 120 included )	460	460	460
<b>LT</b> Hook-lift length	2800	3000	3200
<b>L1</b> Dist. from hook to rear rollers	2600	2800	3000
<b>L2</b> jib move	685	850	850
Unit shipping weight	370	380	380
<b>H1</b> Hook height		920	
<b>H2</b> Installation height		130	
<b>H3</b> Internal tunnel height		100	
<b>R</b> Minimum loading / unloading height	1731	1931	2131

Indicated figures are for information only and can be changed without any prior notice

User's friendly – Insured Resale - Long lifetime –  
Reduced maintenance cost - Options available

### Mechanical structure :

- Steel with high tensile strength
- Subframe with Z profil and crossmembers
- Rear articulations reinforced.
- A perfect mastery of the Jib movement through machined articulation pivots.
- Modular concept of components for large scope of combination.
- Modular assembling concept.

### Hydraulics :

- Integrated safety device to prevent miss-use of the equipment.
- Main cylinder equipped with check valves
- Electrical remote control box in the cabin with cinematic display.



### Main options :

- Electro-pump 12 ou 24 V
- Subframe ZTP width 752 mm
- Container with rails width at 850 mm ( instead of 1060 standard )



Usine et siège social - plant and head office  
Rond-Point Auguste Colonna - B.P.70056 - 42161 Andr zieux-Bouth on cedex – France

Site internet : [www.marrel.com](http://www.marrel.com) / e-mail : [contact@marrel.com](mailto:contact@marrel.com) / Standard : +33 (0)4 77 36 28 28

January 2012 Rev : Ind 00