



**Global Environmental Products Inc.** offers equipment with uncompromising performance, consistent quality, durability and reliability. Our comprehensive range of machines provide the right cleaning equipment for your application. Please contact us for a demonstration at (909) 713-1600.

- ▶ Reliable / Durable Equipment
- ▶ Innovative Engineering / Design
- ▶ Industry Leading Reputation
- ▶ Dedicated Customer Service
- ▶ Outstanding Sales Professionals
- ▶ Fast Parts and Service
- ▶ National Dealer Network

[www.GlobalSweeper.com](http://www.GlobalSweeper.com)

MADE IN THE USA



Sold and Serviced by:



**ISO**  
9001:2015  
CERTIFIED

**Global Environmental Products**  
5405 Industrial Parkway  
San Bernardino, CA 92407 USA  
909-713-1600  
[info@globalsweeper.com](mailto:info@globalsweeper.com)



**Purpose-Built, Maneuverable, Powerful, Quiet and Simple**

© Copyright 2022, Global Environmental Products, Inc. • Specifications may change without notice. • V-031622



**AIR**  
GLOBAL



**100% PLUG-IN ELECTRIC HEAVY-DUTY  
REGENERATIVE AIR STREET SWEEPER**

**GLOBAL R4 AIR EV**

*Introducing the First Heavy-Duty Class 7  
Plug-In 100% Electric Drive Rechargeable Regenerative Air Sweeper  
Purpose-Built, Maneuverable, Powerful, Quiet and Simple*

- ▶ 18.6' Turning Radius
- ▶ Cab-Over Design with Unmatched Visibility
- ▶ Large 47" Gutterbrooms Designed to Clean the Curb
- ▶ Large 32" Diameter Impeller
- ▶ Unmatched Access to Sweeping Components
- ▶ Large 5.8 Cubic Yard Hopper with Access Door
- ▶ 100% Stainless Steel Hopper Construction
- ▶ **ZERO EMISSIONS and 8 Hours of Operational Time**

**ZERO EMISSIONS**  
FOR A GREENER TOMORROW





## 100% PLUG-IN ELECTRIC CLASS 7 REGENERATIVE AIR SWEEPER WITH ZERO EMISSIONS

### THE ULTIMATE PERFORMANCE AND AGILITY ZERO EMISSIONS

From the modern, comfortable and well appointed operator's cab, to the toughest and most rugged Regenerative-Air Type sweeping system ever built, the **Global R4AIR EV** is designed to take on the worst of the worst sweeping conditions.

**The performance matched 32" Suction Fan and 72" Wide Pick-Up Head** provide superior sweeping of all heavy debris quickly and efficiently. The purpose-built chassis is based on four decades of experience designing the most effective, and safe, street sweepers in the industry

The 130-inch wheelbase allows for the sweeper to reach a **turning radius of 18 1/2', wall-to-wall**. With the pickup Head in the center you don't have to worry about what is happening behind you. **Global R4AIR EV is the only 4-Wheel Air Type Street Sweeper in the market that can be utilized virtually anywhere with the ability to HIGH-DUMP into a dump truck.**

#### Global R4AIR EV Standard Equipment

- Air Conditioned and Pressurized Cab
- In-Cab Gutterbroom Pressure Adjustment
- Front and Rear Chalmers Suspension
- Rear View Camera and LCD Monitor
- 72" Wide Pick-Up Hood, 32" Impeller
- LED Headlights
- Hopper Access Door
- 100% Stainless Steel Hopper Construction

#### Global R4AIR EV Options

- In-Cab Gutterbroom Tilt
- In Cab Gutterbroom Speed Control
- AM/FM/CD Stereo with AUX/USB Port and BlueTooth
- Air-Ride Seat
- Hopper Wash Out System
- Suction Hood Wash Out System
- Curtain Lift Arm Leaf
- Automatic Greasing System
- PM-10 Water System (Meets South Coast AQMD Rule1186)



**THE BEST TURNING RADIUS & EXCEPTIONAL VISIBILITY** With the center mounted cab/forward layout the operator has unsurpassed visibility of the road surface as well as pedestrians and surrounding traffic. The 130-inch wheelbase allows for the sweeper to reach a **turning radius of 18 1/2', wall-to-wall**. With the pickup Head in the center you don't have to worry about what is happening behind you. The **Global R4AIR EV's** exceptional visibility increases operator and pedestrian safety.

#### THE ULTIMATE SWEEPING SYSTEM

The Sweeping system consists of **72" Wide Pick-Up Hood with Carbide Dirt Shoes**, combining both with a **Large 32" Suction fan** equals to one of the most powerful AIR Street Sweepers available today.



#### POWERFUL GUTTERBROOMS

**Large 47" Digger-Type Gutterbrooms** allow for superb cleaning of curbs and help guide the debris to the 72" wide Pick Up Hood. Combined with a Large 32" Suction fan equals one of the most powerful AIR Street Sweepers available today.

#### DUST SUPPRESSION SYSTEM

**Global R4AIR EV** includes **250-Gallon Water Tank Capacity** combined with **Two(2) Diaphragm Water pumps** and **Two(2) Modes (LOW/HIGH)** provide versatility and superb dust control.



#### LARGEST HOPPER IN IT'S CLASS

**Global R4AIR EV** includes a **5.8 cu/yd 100% Stainless Steel hopper construction**, Cyclone Type Dust Separators and **Swing-Down Hopper Screens** are easy to clean.

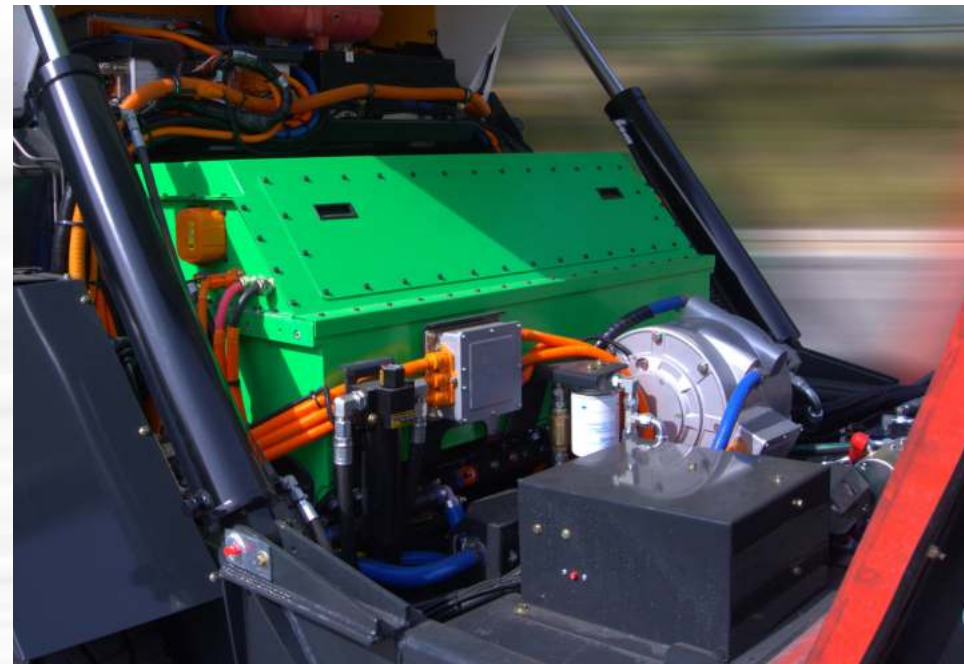

#### ALL ELECTRIC DRIVE SYSTEM

- **Large Batteries will last for up to 11 hours of operation. With a 10 Year Life Span, the Batteries are designed to last and will not have to be replaced.**
- **Standard SAE J1772 Level II 240V Charging System will replenish the battery in 8 hours.**
- **J1772 SAE Level III Supercharging System is available as an option, recharging time of 4 hours.**

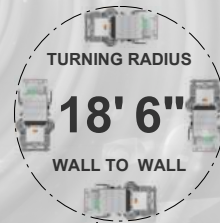

**Designed to Prevent Sand-Blasting** Designed for **Durability, Easy Access, and Long Service Life.**

The **Global R4AIR EV** offers the best maneuverability in its class with its tight turning radius that allows the operator to maneuver easily in cul-de-sacs and close quarters.

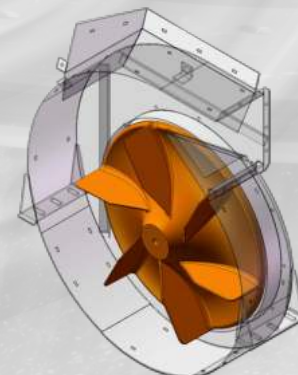

#### THE ULTIMATE AIR SWEEPING SYSTEM

**Large 32" Diameter Impeller** includes wear-resistant coating. The **Internal Impeller Housing** components include **Rubber Lining**. Driven **Hydraulically**, Impeller will reach speed of **3,000 RPM** independent of Sweeping Speed.



### ZERO EMISSIONS FOR A GREENER TOMORROW

- ▶ **Very Quiet Sweeping Operation**
- ▶ **Up to 8-Hours of Continuous Sweeping Time with 210KW Lithium Ion Battery Pack**
- ▶ **240V Charging System Standard**
- ▶ **Top Travel Speed Of 55-MPH**
- ▶ **All Electric Propulsion System Eliminates Transmissions And Reduces Maintenance**
- ▶ **No Diesel Engine And No DPF System Allows For Lower Total Cost Of Operation**
- ▶ **The Only Heavy-Duty Plug-In Electric Street Sweeper In The USA!**



**IT'S ALL IN THE OPEN** Hydraulic Hoses are NOT hidden in the frame of the sweeper, while all Manifolds and Filters are located in a central location.

#### EASY TROUBLESHOOTING

A centralized, weatherproof systems locker fully protects electrical components from the elements while it allows maintenance staff easy accessibility for inspection and troubleshooting.

